



# STEAM DEGREASER

## STEAM & PRESSURE CLEANER

**Positive emulsion—  
spontaneously  
emulsifies greasy soil  
to improve cleaning—  
prevents soil/dirt  
redeposition**

**Heavy duty balanced  
alkaline builder blend  
—enhances soil  
suspension, digests oil  
and grease, enhances  
rinseability—  
conditions cleaning  
water**

**Surface safety—built-  
in corrosion inhibitor,  
anti-rust agent**

**Low scale formula—to  
prevent alkali build up  
in hot and cold water  
pressure washers**

**USDA rating—A-1**

### Available In Sizes

Quart	AC00743
5 Gallons	AC00737
55 Gallons	AC00744

Wear safety equipment recommended on MSDS, place wet floor signs and read all directions and cautions prior to beginning work.



### Professional Recommendations

- This is an excellent “catch-up” cleaner that will perform best when used regularly
- If applying with a pressure washer, stay out of mist
- Overlap your cleaning passes to assure uniform cleaning
- **Not** recommended for removal of baked-on or dried, hardened soils—use a cleaner that is solvent fortified

### Application

Industrial heavy duty maintenance cleaner — floors, walls, machinery, hoods, sumps, vent systems through mechanical cleaning devices.

### Specifications

Appearance .....	Clear, red liquid
Odor.....	Mild, characteristic
Density (lbs/gal)(±0.1 @20°C) .....	8.76
pH (Conc./1%)(±0.5@20°C).....	13.5/11.7
Refractive index (±.0020@20°C).....	1.3492
Hard water tolerance (as ppm CaCO3) .....	>8000 ppm
Solvent %.....	None
Flashpoint (TCC) .....	None
USDA rating.....	A-1
Foam generation .....	Moderate
Stability (40°-120°F).....	Stable
Freeze/thaw stability.....	OK, 3 cycles
Shelf life (closed containers, 40°-120°F) .....	1 year minimum



Wear safety equipment recommended on MSDS. Read all directions and cautions prior to beginning work.



For Pressure Cleaning: Draw concentrate directly from container. Set dilution using pressure washer manufacturer's directions according to soil present.

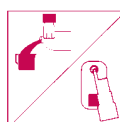

Dilute **Steam Degreaser** with water as follows:  
Heavy soil: 5:1 (26 oz. per gallon)  
Moderate soil: 20:1 (6 oz. per gallon)  
Light cleaning: 50:1 (2.5 oz. per gallon).



Apply to surface liberally while scrubbing. Allow to work. If soil is heavy, double scrub with an autoscrubber (First pass, squeegee up; second pass, squeegee down, vac on). Pick up as much solution as possible. If possible, allow floor to dry before traffic resumes on cleaned area.